

## ◀30X30X10mm Series▶

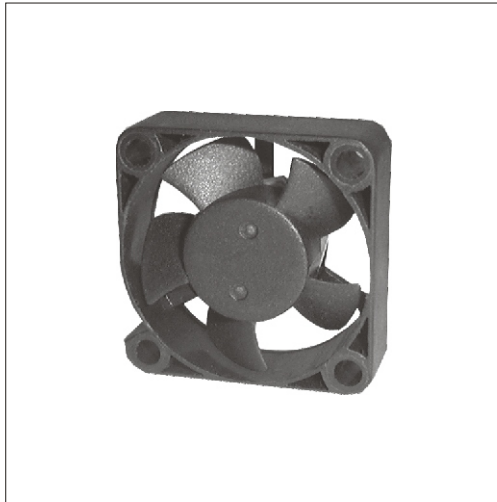

Spot cooling,also suitable for small space requirements, laptops PC and notebook,etc.,.

### External Dimensions

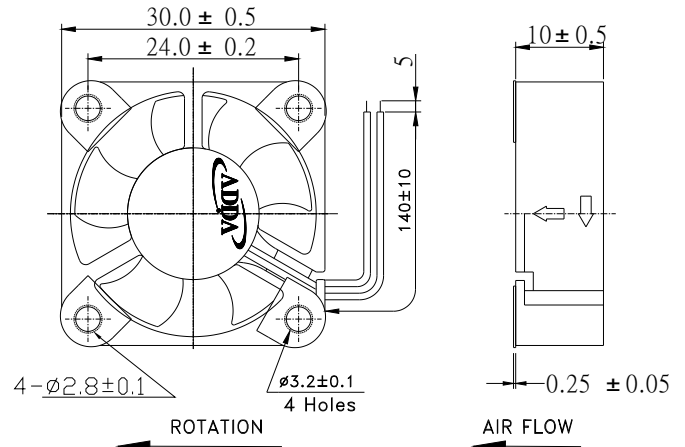

Frame:Plastic(UL:94v-0)  
Impeller:Plastic(UL:94v-0)  
Bearing:Hypro bearing  
Lead wire:UL1571AWG28  
OPERATING TEMP\*:-10C~70C  
VOLTAGE AVAILABLE:5V,12V  
\*:-10C~60C for fans with sleeve/ball combination bearings.

### Specifications(Nominal)

\*:Noise is measured at the distance of one(1) meter from the axis of intake.

Frame size (mm)	Model No.	Bearing System Type	Rated Voltage (v)	Rated Current (A)	Rated Power (W)	Rated Speed (rpm)	Bearing type: =Ball =Sleeve =1B1S =Hypro bearing				Noise Level (dB/A)	Weight (g)
							Maximum AirFlow (CMM)	Maximum AirFlow (CFM)	Maximum Pressure (InAq)	Maximum Pressure (mmAq)		
30x30x10	AD0305DX-G50		5	0.09	0.45	5500	0.062	2.18	0.063	1.58	17.0	8
	AD0305LX-G50		5	0.12	0.60	8000	0.091	3.21	0.122	3.06	20.2	
	AD0305MX-G50		5	0.13	0.65	9000	0.107	3.78	0.170	4.24	28.0	
	AD0305HX-G50		5	0.17	0.85	10500	0.127	4.48	0.219	5.47	30.7	
	AD0312DX-G50		12	0.06	0.30	5500	0.062	2.18	0.063	1.58	17.0	
	AD0312LX-G50		12	0.07	0.35	8000	0.091	3.21	0.122	3.06	20.2	
	AD0312MX-G50		12	0.12	0.60	9000	0.107	3.78	0.170	4.24	28.0	
	AD0312HX-G50		12	0.11	0.55	10500	0.127	4.48	0.219	5.47	30.7	
	AD0305DX-G51		5	0.09	0.45	5500	0.062	2.18	0.063	1.58	17.0	
	AD0305LX-G51		5	0.12	0.60	8000	0.091	3.21	0.122	3.06	20.2	
	AD0305MX-G51		5	0.13	0.65	9000	0.107	3.78	0.170	4.24	28.0	
	AD0305HX-G51		5	0.17	0.85	10500	0.127	4.48	0.219	5.47	30.7	
	AD0312DX-G51		12	0.06	0.30	5500	0.062	2.18	0.063	1.58	17.0	
	AD0312LX-G51		12	0.07	0.35	8000	0.091	3.21	0.122	3.06	20.2	
	AD0312MX-G51		12	0.12	0.60	9000	0.107	3.78	0.170	4.24	28.0	
	AD0312HX-G51		12	0.11	0.55	10500	0.127	4.48	0.219	5.47	30.7	

Specifications subject to change without notice.

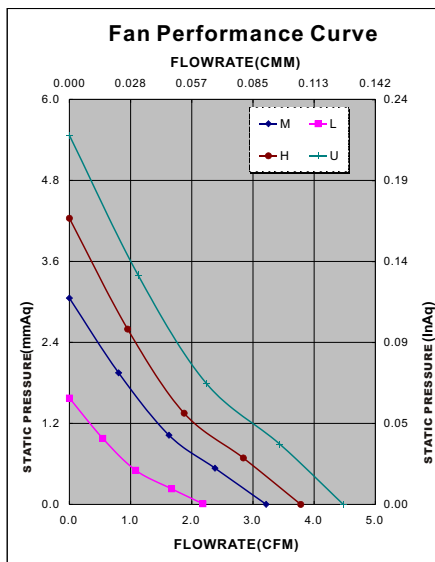

\*Motor protective circuit and third lead wire functions

0	1	2	3	4	6	7	8	9	A	B
✓	✓	✓	✓		✓					✓

\*Safety approvals

✓	✓			✓	✓					

